



# Inspiration...

14th September 2018

Inspiration 57

**Inspiration:** Gustafs - Customisation and Bespoke Solutions

**Supplier:** Gustafs Scandinavia

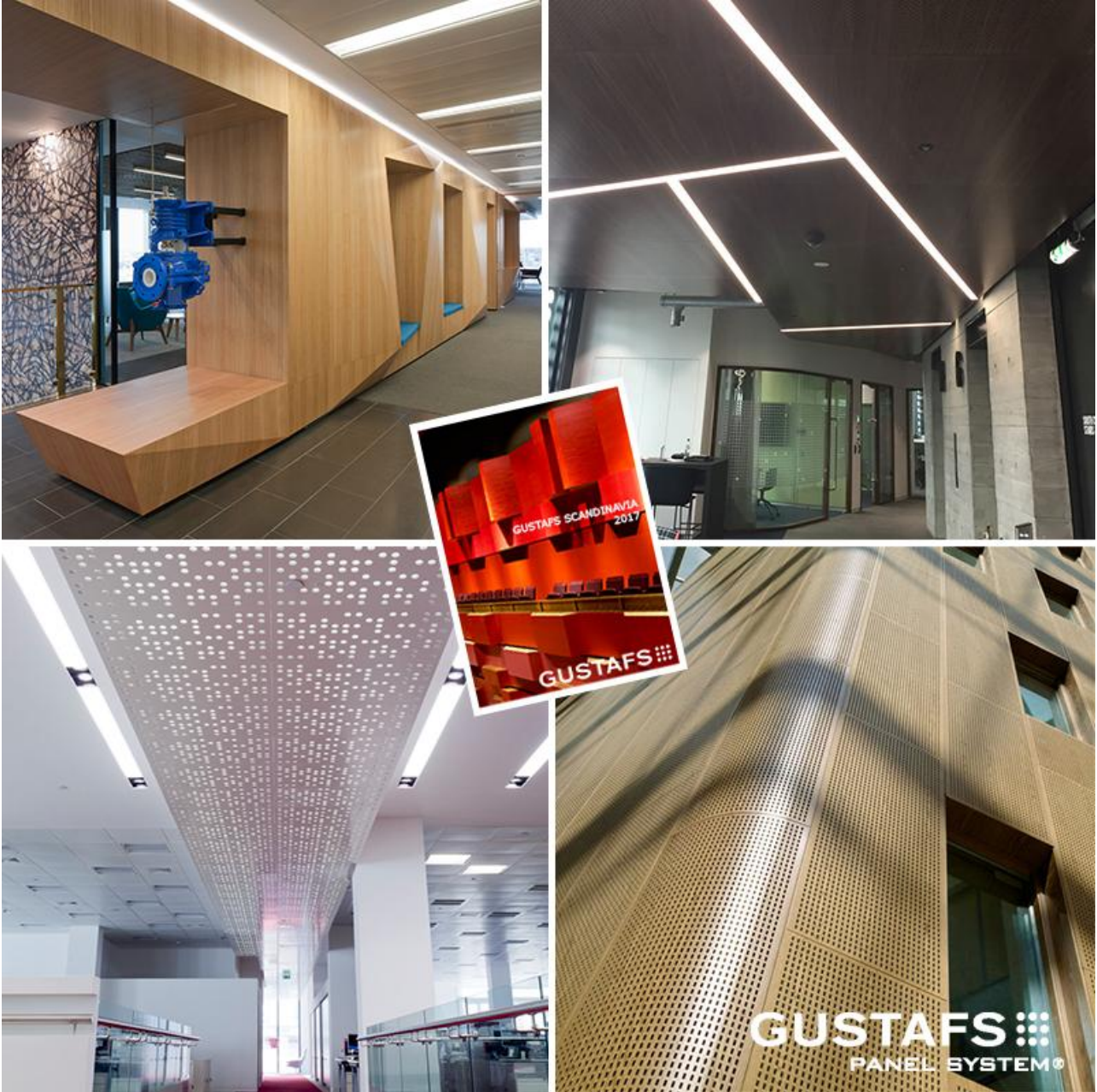

Clockwise: Catlin Insurance, London (2011) Southmead Hospital, Bristol (2013) 1 West Regent Street, Glasgow (2017) Capital One, London (2018)



**Gustafs Scandinavia**  
Est. 1913  
Dalarna, Sweden



LSA Projects Ltd are the exclusive supplier of 7 major European manufacturers of solid and veneered timber wall and ceiling solutions and high-end metal ceilings as well as industry leading changing room and locker producers and locking system creators.

At the core of the supplier selection process is an ability to work directly with these companies to manage and develop new products as well as designing bespoke solutions for clients within the scope of the elegant systems of their signature products.

We are proud to have been working alongside Gustafs and our other suppliers for almost 20 years; working with architects, interior designers, contractors, and directly with customers to deliver a huge range of products to large and small projects across the UK and Ireland.

Gustafs Scandinavia of Dalarna Sweden have been working with wood since 1913; over 100 years of business has grown the family owned joinery into a globally renowned cladding manufacturer. Their design and production procedures alongside their innovative Capax installation grid system help to streamline the build process once the product is ready to pass over to our expert installers.

The unique [Capax installation system](#) alongside the 10 different panel edging options allow for 30 different panel joints and corners in addition to options for mitred and other non-standard edges for corners other than 90° and to meet pre-defined curves for an elegant finish around any corner.

In addition to the versatile Capax system, there are other customisations available within the umbrella of standard Gustafs panels. Panels can be perforated in a choice of [40 pre-defined styles](#) (including the invisible nano perforation) to achieve various levels of acoustic control with the option of a completely custom perforation pattern.

Custom finishing is also available from the factory; in addition to a wide range of natural wood veneers, staining, painting and glossing options panels are available with inset or backlighting to compliment perforations and a range of digital design printing as well as full metallic or metallic design application, specialist veneers and finishing materials including laminates and metals.

Having roots in manual carpentry, the Gustafs production system and their expert workforce use a mixture of the signature veneered gypsum product and solid timber to create bespoke design elements as well as practical solutions for complex installations. Gustafs panels and linear system pieces can also be cut down and modified once on site to achieve an accurate finish.

Over the last 18 years we are delighted to have supplied over 60,000m<sup>2</sup> (almost 10 football pitches) of Gustafs Panel System and Linear Systems to the UK Market with our 2 largest orders Southmead Hospital (2014) and Royal Holloway University (2017) coming in at over 4,000m<sup>2</sup> each! We have lots of great new projects in the pipeline for the rest of 2018 and into 2019 and 2020 and we can't wait to supply the next 60,000m<sup>2</sup>!

Gustafs Panel System and Linear Systems are available in the UK only through LSA Projects Ltd.

If this inspires you for one of your projects we would love to hear from you!

Please follow the link on the right to download the Gustafs brochure.

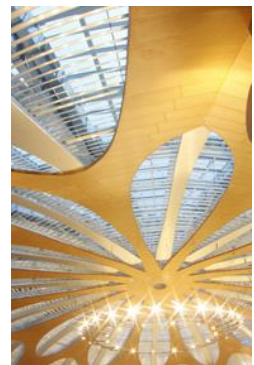
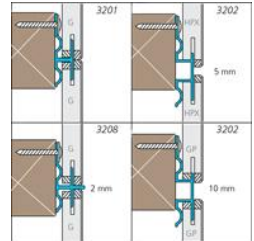

LSA Projects Ltd | The Barn White Horse Lane Witham Essex CM8 2BU



iNSPIRATION  
home

t: +44 (0) 1376 501199

e: [rwarder@LSAProjects.co.uk](mailto:rwarder@LSAProjects.co.uk)

w: [www.LSAProjects.co.uk](http://www.LSAProjects.co.uk)

[Find us on Facebook](#)

[Follow us on Twitter](#)

[Connect with us on LinkedIn](#)



[Click here](#) to learn more about the product used and [here](#) to download this email as a pdf.  
If you do not wish to receive these emails in future, please click [here](#) to unsubscribe.